

# FULL SERVICE SEAL KIT FOR LOWER PRESSURE CALIBRATION PUMP

## MODEL PGL

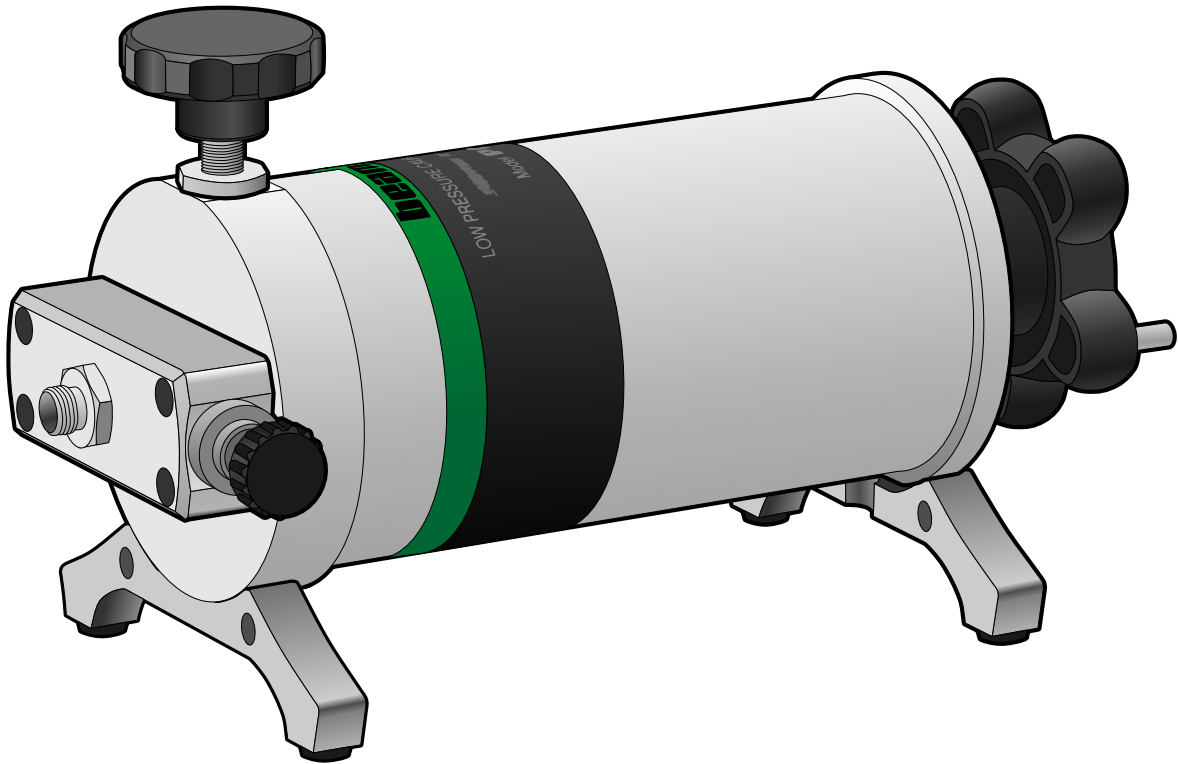







Dear user,

We have made every effort to ensure the accuracy of the contents of this manual. Should any errors be detected, we would greatly appreciate to receive suggestions to improve the quality of the contents of this manual.

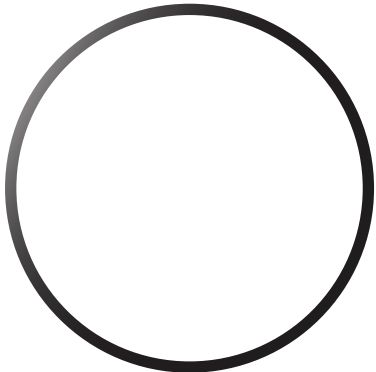
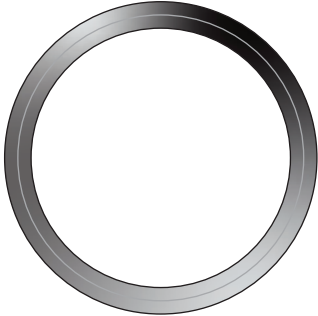
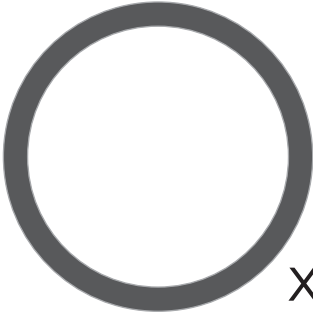
For more detailed technical data about Beamex PGL Low Pressure Calibration Pump, please contact the manufacturer.

# Contents of the Service Seal Kit

The content of PGL Service Seal Kit is listed in the table below.

Seals	Size in mm	Description	Symbol
	46,0 * 2,0	Extra o-ring, not relevant for PGL	
	35,0 * 3,5	Coarse Adjust piston star shape o-ring	D
 x2	41,0 * 3,2	Coarse Adjust piston retainer ring	E
 x2	12,0 * 2,0	Fine Adjust upper o-ring	B
 x2	6,0 * 1,5	Fine Adjust lower cylinder o-ring	C
 x2	10,5 * 1,5	Release Valve o-ring	A
 x2	5,0 * 3,0	Extra o-ring, not relevant for PGL	
		Release Valve needle	

## NOTICE

Maintenance and/or repair of the PGL pump must be performed with the Release Valve open.

## NOTICE

Maintenance and repair must only be performed by authorized personnel.

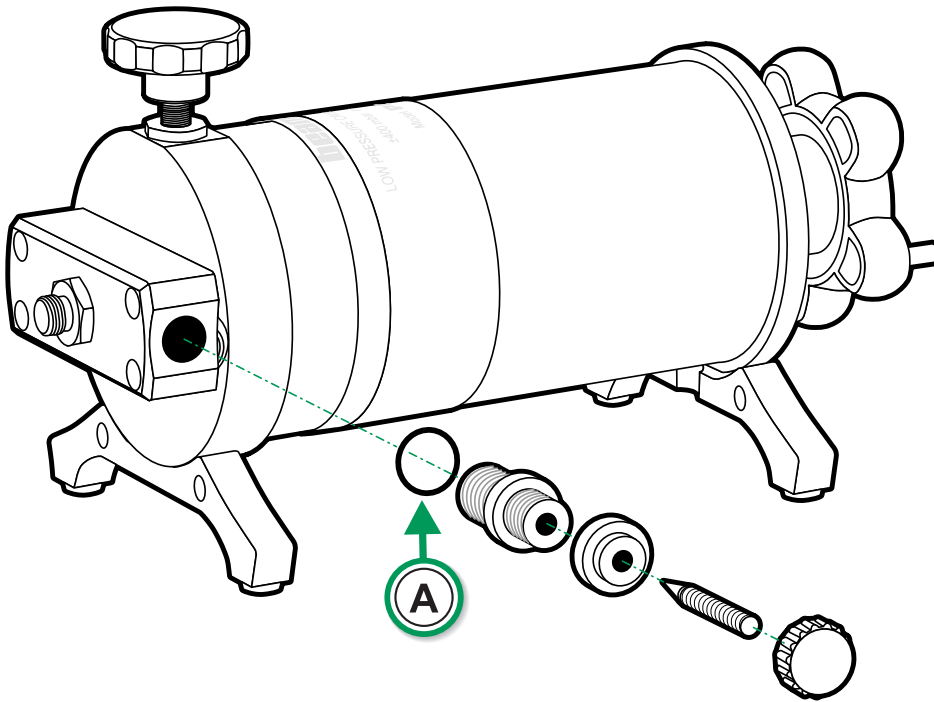

Figure 1. Release Valve seal (A).

## Replacing the Release Valve seal

To replace the **Release Valve seal**, follow steps below:

1. Remove the Release Valve needle by unscrewing it counterclockwise.
2. Unscrew the Release Valve base cover by hand and then use a needle nose pliers tool to remove the release valve base.
3. Replace the Release Valve seal and reassemble the Release Valve in the reverse order. Please note to apply lubrication on the Release valve needle thread.

## NOTICE

### PGL Pump models

Before proceeding with next steps, check the pump model of your PGL pump.

**Old model: Serial number < 12630**

**New model: Serial number > 12630**

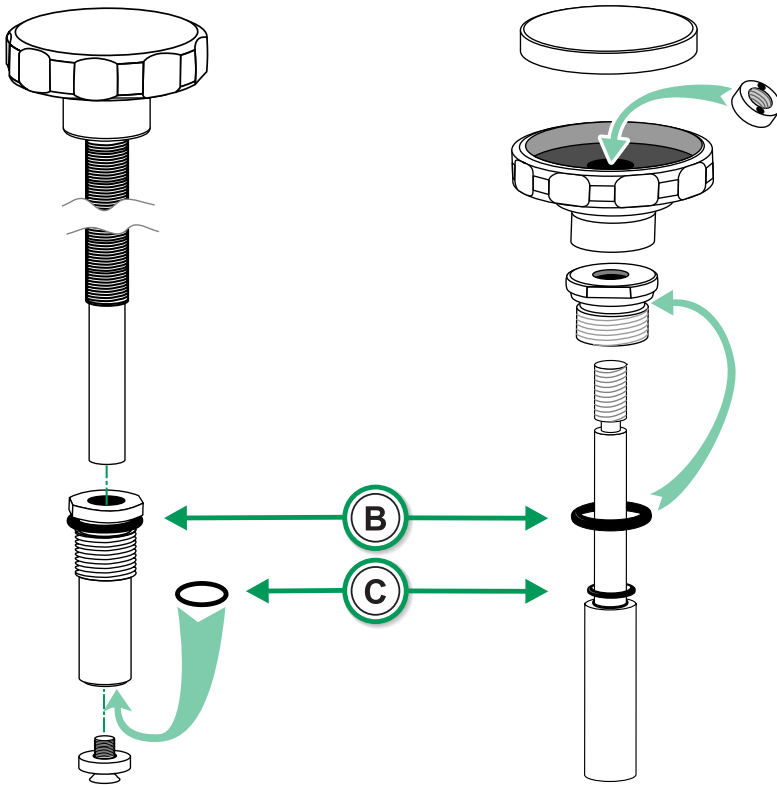

Figure 2. Fine Adjust Section seals (**old model on the left, new model on the right**).

## Replacing O-rings in the Fine Adjust Section

Depending on the pump model, follow the correct steps:

### Old model

1. Use a 17mm spanner to unscrew the Fine Adjust Section (counterclockwise).
2. Replace the upper seal (B) with the spare part.
3. Use the Phillips screw driver to remove the stopper at the bottom of the Fine Adjust Valve. Then you can disassemble the piston from the cylinder.
4. The lower seal is located at the bottom end of the cylinder as shown in Figure 2 (C, left).
5. Replace the seal (C) with the spare part and reassemble the Fine Adjust Section.

## New model

1. Use a 17mm spanner to unscrew the Fine Adjust Section (counterclockwise).
2. Lever the Fine Adjust Knob cap to locate the Fine Adjust base nut inside of the knob.
3. Use needle nose pliers to unscrew the base nut. The Fine Adjust Section will split apart.
4. Replace the seals (B and C) with the spare part and reassemble the Fine Adjust Section.

## NOTICE

Following procedure concerns only the new pump model.

## Replacing piston seals inside the cylinder

To replace the piston seals inside the cylinder follow the steps below:

1. Use a 2,5mm socket head screw driver to unscrew the 2 socket head screws of the support feet.
2. Use a cross screw driver to remove the 3 screws on the shell. Carefully remove the front cover.

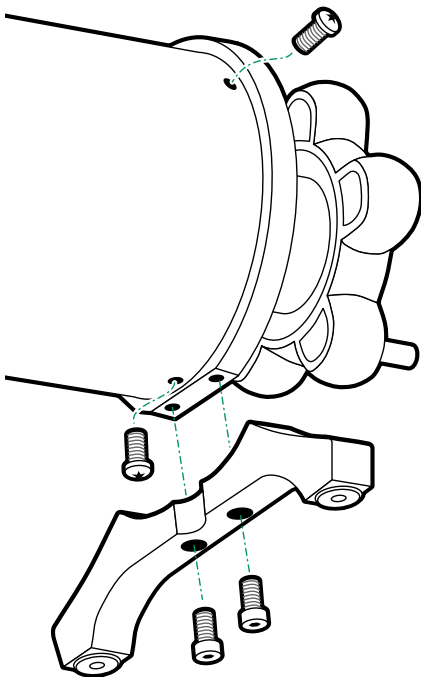

Figure 3. Removing support feet and the front cover.

3. Use a 2,5 mm socket head screw driver to unscrew the 4 socket head screws on the flange. Whole piston can be pulled out.
4. Replace the **Coarse Adjust piston retainer rings (E)** and **Coarse Adjust piston star shape o-ring (D)**.
5. Apply the lubrication (silicone grease) to the piston section.
6. Reassemble the pump in reverse order.

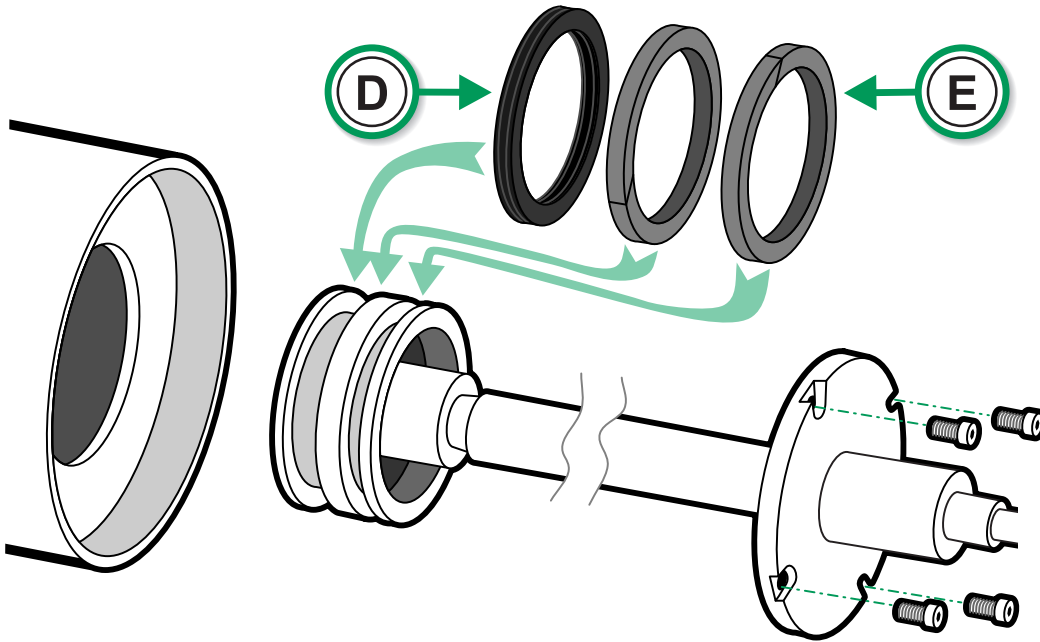

Figure 4. Replacing piston seals (D and E) inside the cylinder.